



Infotech Ltd

www.zenithinfotech.com

Backup & Disaster Recovery Platform



Zenith Backup Guardian

Zenith's Backup Guardian Service offers monthly backup and failover server testing performed by our support personnel, freeing time and easing your mind that client backups are reliable. In the event of a disaster, your servers can be hosted at our collocation.

Features

- Monthly backup testing and verification
- Monitored BDR replication
- Monthly server failover testing with integrity checks
- Mounting backup images at the Zenith Collocation
- Collocation-level server virtualization (Hot Site)

Web-Based Portal

Features

- Centralized Management
- Performance Metrics
- Remote Control
- Patch Management
- Centralized Reporting
- Ticketing
- Online Chat Support
- Alerts & Notifications
- Configuration Management



BDR Models	BDR100T/TS G2	BDR1100T/TS G2	BDR2100T/TS G2	BDR2100R/RS G2	BDR3100R/RS G2
Form Factor	Tower	Tower	Tower	2U Rackmount	2U Rackmount
CPU	Athlon Dual Core	Opteron Dual Core	Opteron Quad Core	Opteron Quad Core	2xOpteron Quad Core
RAM	4GB	8GB	8GB	8GB	16GB
Data Volume	1TB (1TBx1)	1TB (1TBx2 RAID 1)	2TB (1TBx3 RAID 5)	2TB (1TBx3 RAID 5)	4.5TB (1TBx6 RAID 5)
Max Number of Servers to be backed up	3	3	8	8	16
NIC	1x10/100/1000 Mbps	2x10/100/1000 Mbps	2x10/100/1000 Mbps	2x10/100/1000 Mbps	2x10/100/1000 Mbps
Bundled Mailbox Recovery Licenses	50	50	100	100	200
3 Year Maintenance and Warranty	Included	Included	Included	Included	Included
Additional Mailbox Licenses	Available	Available	Available	Available	Available
Extended Monitoring and Warranty	Available	Available	Available	Available	Available

Bare Metal Restore



Features

- Virtual to physical restores
- Virtual to virtual restores
- Restore to dissimilar hardware
- Integrated driver support
- Multiple partition restores
- Windows domain controller support

- Restore to Dissimilar Hardware
- Boot to the BMR recovery environment
- Map a drive to the BDR
- Install the necessary drivers
- Restore from backup image

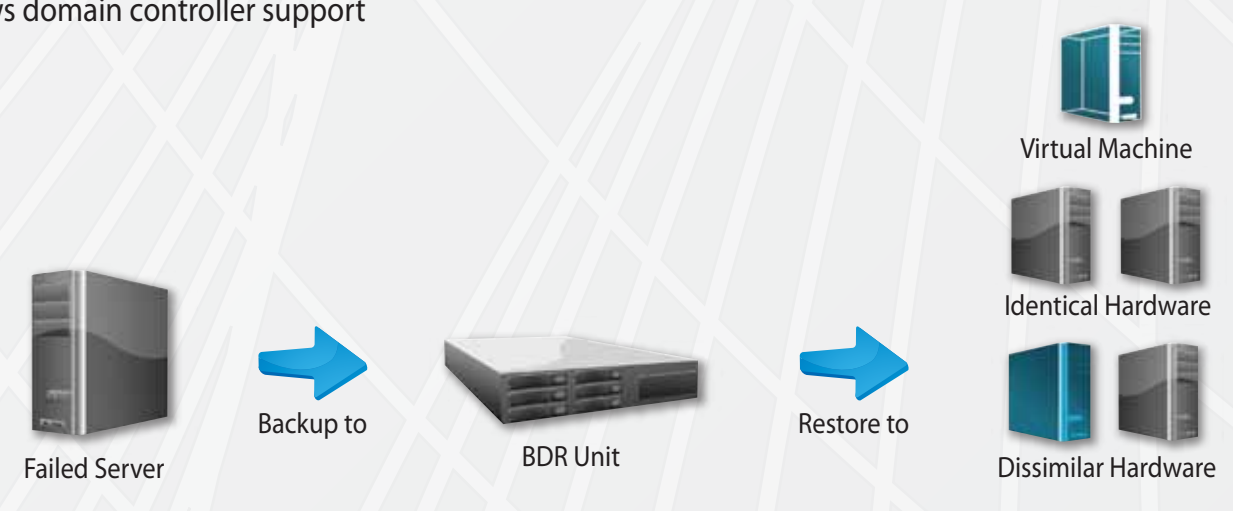

Backup & Recovery



Features

- 15-minute snapshots
- 256-bit AES encryption
- Windows server support for 32 and 64-bit OS's
- Disk based backup
- File & folder restores
- System restores
- Recover using drag & drop functionality
- Exchange message level recovery
- Database & application level recovery
- VSS aware
- Sync to external drive options
- Multiple restore points local & offsite

- Backup & Recovery
- Select server volumes for backup
- Set the backup schedule
- Install the backup agents
- Execute backup jobs
- View reports on web-based portal

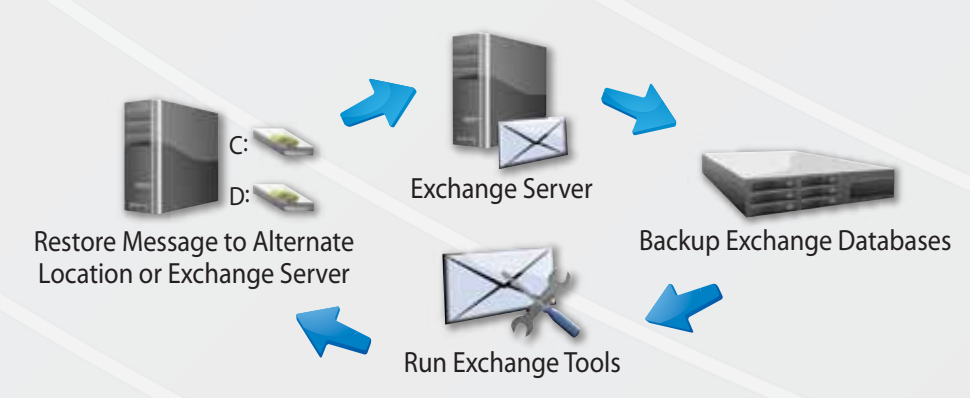

Stand by Servers



Features

- Runs directly from the NAS
- Virtualize a server in less than 30 minutes
- Hardware independent
- Shorten RTO's
- Select a point-in-time snapshot just before the failure
- Virtual server will have the same network settings
- Backups occur during virtualization
- Virtualize directly from backups
- Perform real or test virtualizations
- Perform a BMR back to your production server

- Server Virtualization
- Identify server to be virtualized
- Specify RAM
- Select virtualization mode
- Select backup file
- Run Migration Wizard
- Boot virtual machine



Replication Options

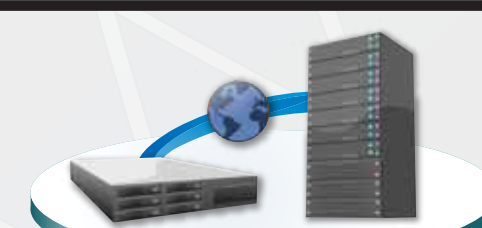

Managed Offsite Transfer

Features

- Transfer the base image and incrementals via external drive
- Incremental file transfer over the wire to our collocation
- 256-bit AES encrypted tunnel
- Scheduling options
- Packet level verification
- Bandwidth configuration and transfer analyzer
- Backups replicated once per day
- Error notification and reporting

BDR Replication

Features

- Replicate to BDR, ARCA, or Vault
- 25 Concurrent connections
- Restore from anywhere
- Custom scheduling
- Integrated email alerting
- Bandwidth throttling
- Encrypted tunnel

